

## Old locking system 4000

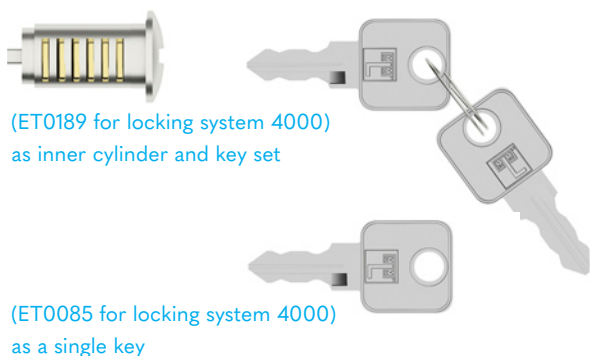

(ET0189 for locking system 4000)  
as inner cylinder and key set

(ET0085 for locking system 4000)  
as a single key



Dismounting key  
for locking system 4000 (independent on lock number)

## New locking system 18000

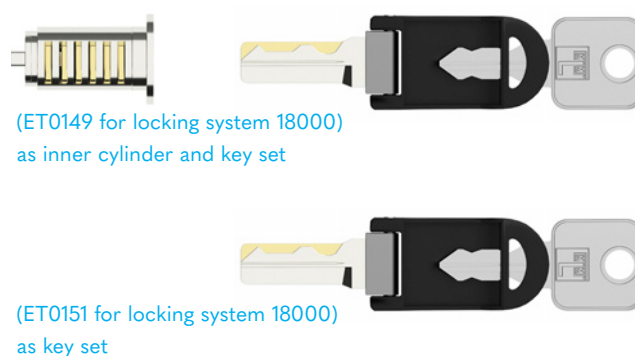

(ET0149 for locking system 18000)  
as inner cylinder and key set

(ET0151 for locking system 18000)  
as key set



Dismounting key  
for locking systems 18000 and 19000 (independent on lock number)

## Spare parts order form

### Master, emergency and dismounting key.

#### Note on the security

Anyone who possesses a master or emergency key for our series of units can open all the locks in the associated locking system and therefore has access to their contents!

For your own security, therefore, only the management of your institution is authorised to order a master key, e.g. the school administration or company management. These persons will then pass on the key internally at their own discretion.

The key will be delivered separately to the person who ordered it. Shipment is insured and undertaken by our parcel service provider.

#### Note on the key number

You will find the key number on the inner cylinder or on the key. Please also see the adhesive label on your model which specifies the order (AB) and model number as well as the week of delivery (LW).

#### Procedure for ordering master keys

Please complete the order form on page 2, sign the document and return it to us. Enter the number of keys on the left next to the price.

#### Procedure for ordering keys and inner cylinders

Please complete the order form on page 2.

Enter all the required key numbers and the corresponding number of units under the appropriate locking system.

Keys for the locking systems 6000, 7000, BN and >18501 are not available ex stock. The delivery therefore takes approximately three weeks. The delivery period for keys for the locking systems 18001–18500 and 4000–4099 is approximately one week.

Inner cylinders for the locking systems 18000, 4000, 6000 and 7000 are compatible with one another.

	Quantity	unit price
<b>68-995-99 Master key</b>	_____ x	<b>25.00</b>
Opens and closes lock <a href="#">LE 18001-18500 HSA12</a>		
<b>68-996-99 Master key</b>	_____ x	<b>25.00</b>
Opens and closes lock <a href="#">LE 18501-19000 HSB12</a>		
<b>68-997-99 Master key</b>	_____ x	<b>30.00</b>
Opens and closes lock <a href="#">LE 18001-19000 GHS12</a>		
<b>68-994-99 Dismounting key</b>	_____ x	<b>19.50</b>
Dismounts lock <a href="#">LE 18001-20000 MAB00 (red)</a> only when open		
<b>68-999-01 Master and dismounting key</b>	_____ x	<b>30.00</b>
Opens and dismounts lock <a href="#">LE 18001-18500 MA12</a>		
<b>68-999-02 Master and dismounting key</b>	_____ x	<b>30.00</b>
Opens and dismounts lock <a href="#">LE 18501-19000 MB12</a>		
<b>68-999-DE Dismounting key</b>	_____ x	<b>7.94</b>
Opens and dismounts locking systems <a href="#">4000</a> (key numbers: _____ )		
<b>68-714-00 Emergency key Z1 for combination lock</b>	_____ x	<b>35.00</b>
Opens combination lock <a href="#">Fix/Free 57/58</a> , as of approx. July 2016		
<b>68-708-00 Code finder for combination lock</b>	_____ x	<b>12.00</b>
<b>68-707-00 Emergency key AA01 for combination lock</b>	_____ x	<b>35.00</b>
Opens combination lock approx. March 2013–June 2016		
<b>68-735-00 Emergency key H-ZC 224 for combination lock Burg</b>	_____ x	<b>35.00</b>
Opens combination lock approx. November 2012–March 2013		
<b>ET0149 Inner cylinder with key set (1x fixed, 1x flip)</b>	_____ x	<b>16.13</b>
For locking systems <a href="#">18001-18500</a> (key numbers: _____ )		
<b>ET0189 Inner cylinder with key set (2x fixed)</b>	_____ x	<b>18.96</b>
For locking system <a href="#">4000</a> (key numbers: _____ )		
<b>68-999-IZ Inner cylinder with key set (2x fixed)</b>	_____ x	_____
For locking system <a href="#">6000</a> , <a href="#">7000</a> and <a href="#">&gt;18501</a> (key numbers: _____ )		
<b>ET0151 Key set (1x fixed, 1x flip)</b>	_____ x	<b>9.61</b>
For locking system <a href="#">18001-18500</a> (key numbers: _____ )		
<b>ET0085 Single key</b>	_____ x	<b>8.08</b>
For locking system <a href="#">4000</a> (key numbers: _____ )		
<b>68-999-SL Spare key</b>	_____ x	_____
For locking system <a href="#">6000</a> , <a href="#">7000</a> , <a href="#">BN</a> and <a href="#">&gt;18501</a> (key numbers: _____ )		
<b>Total net amount</b>	_____	_____

Address:

\_\_\_\_\_

Contact person:

\_\_\_\_\_

Function (e.g. school administration):

\_\_\_\_\_

Tel:

\_\_\_\_\_

Date:

\_\_\_\_\_

Signature:

\_\_\_\_\_